



RESIDENTIAL ESTATE AGENTS  
PROPERTY LETTING & MANAGING AGENTS  
VALUERS & PROPERTY CONSULTANTS  
CHARTERED SURVEYORS

**01722 336422**  
[www.hwwhite.co.uk](http://www.hwwhite.co.uk) WEB



**Polden Road,**

**£1,050 PCM**

**21 Polden Road, Salisbury, Wiltshire, SP1 2JU**



Energy Efficiency Rating		Current	Potential
Very energy efficient - lower running costs			
(92 plus) A			
(81-91) B			
(69-80) C			80
(55-68) D		53	
(39-54) E			
(21-38) F			
(1-20) G			
Not energy efficient - higher running costs			
England & Wales		EU Directive 2002/91/EC	

A charming, well-presented, 2 bed end of terrace house situated close to Salisbury city centre.

The accommodation comprises: Wooden porch leading to a large, open plan kitchen/dining area with storage cupboard and open fire. Double aspect sitting room with fireplace.

First floor with feature fireplace and storage cupboard. Two double bedrooms with double aspect windows. Modern bathroom with shower over.

Outside; Small front garden with pathway to the enclosed rear garden with terrace, lawn and storage shed.

Gas c

Ground Floor

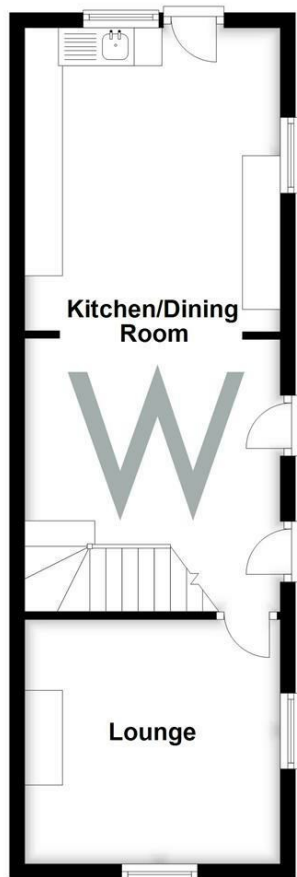

First Floor

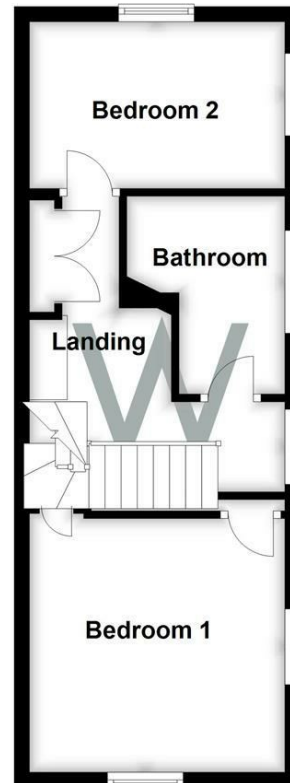

01722 336422

47 Castle Street, Salisbury SP1 3SP 01722 320600 FAX  
 residential-sales@hwwhite.co.uk E-MAIL www.hwwhite.co.uk WEB